



# ANSI FLANGE 400 LB.

## ANSI B16.5 FORGED FLANGES

SLIP-ON

SCREWED

SOCKET WELDING

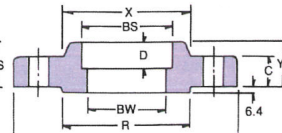
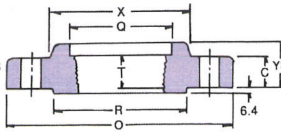
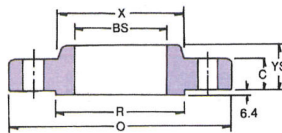
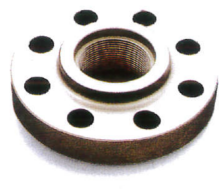

(Dimensions in mm)

Nominal Size (B)	O	C	X	R	A	YS	YW	YL	BS	BW	BL
1/2	95.3	14.3	38.1	34.9	21.3	22.2	52.4	22.2	22.4	14.0	22.9
3/4	117.5	15.9	47.6	42.9	26.7	25.4	57.2	25.4	27.7	18.8	28.2
1	123.8	17.5	54.0	50.8	33.5	27.0	61.9	27.0	34.5	24.4	35.1
1 1/4	133.4	20.7	63.5	63.5	42.2	28.6	66.7	28.6	43.2	32.5	43.7
1 1/2	155.6	22.3	69.9	73.0	48.3	31.8	69.9	31.8	49.5	38.1	50.0
2	165.1	25.4	84.1	92.1	60.5	36.5	73.0	36.5	62.0	49.3	62.5
2 1/2	190.5	28.6	100.0	104.8	73.2	41.3	79.4	41.3	74.7	58.9	75.4
3	209.6	31.8	117.5	127.0	88.9	46.0	82.6	46.0	90.7	73.7	91.4
3 1/2	228.6	35.0	133.4	139.7	101.6	49.2	85.7	49.2	103.4	85.3	104.1
4	254.0	35.0	146.1	157.2	114.3	50.8	88.9	50.8	116.1	97.3	116.8
5	279.4	38.1	177.8	185.7	141.2	54.0	101.6	54.0	143.8	122.2	144.5
6	317.5	41.3	206.4	215.9	168.4	57.2	103.2	57.2	170.7	146.3	171.5
8	381.0	47.7	260.4	269.9	219.2	68.3	117.5	68.3	221.5	193.8	222.3
10	444.5	54.0	320.7	323.9	273.1	73.0	123.8	73.0	276.4	247.7	277.4
12	520.7	57.2	374.7	381.0	323.9	79.4	136.5	79.4	327.2	298.5	328.2
14	584.2	60.4	425.5	412.8	355.6	84.1	149.2	84.1	359.2	330.2	360.2
16	647.7	63.5	482.6	469.9	406.4	93.7	152.4	93.7	410.5	381.0	411.2
18	711.2	66.7	533.4	533.4	457.2	98.4	165.1	98.4	461.8	431.8	462.3
20	774.7	69.9	587.4	584.2	508.0	101.6	168.3	101.6	513.1	482.6	514.4
24	914.4	76.2	701.7	692.2	609.6	114.3	174.6	114.3	584.2	584.2	616.0

# ANSI FLANGE 400 LB.



## ANSI B16.5 FORGED FLANGES

WELDING NECK

LAP JOINT

BLIND

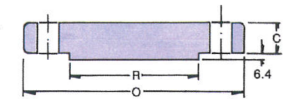
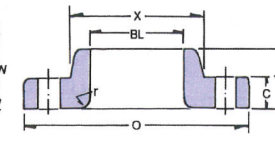
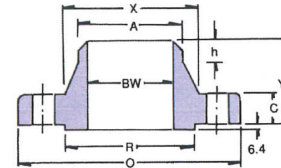
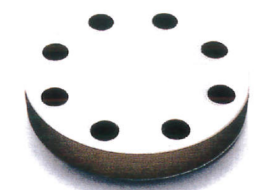

(Dimensions in mm)

h	r	T	D	Diameter of Bolt Circle	Number of Bolts	Diameter of Bolt Holes	Q	kg / pc			Nominal Size (B)	
								SO	WN	BL		
9	3.2	15.9	—	66.7	4	1/2	15.9	23.6	0.6	0.8	0.9	1/2
9	3.2	15.9	—	82.6	4	5/8	19.1	29.0	1.1	1.3	1.4	3/4
9	3.2	17.5	—	88.9	4	5/8	19.1	35.8	1.4	1.7	1.4	1
9	4.8	20.6	—	98.4	4	5/8	19.1	44.5	1.7	2.1	2.0	1 1/4
9	6.4	22.2	—	114.3	4	3/4	22.2	50.5	2.5	3.0	2.7	1 1/2
9	7.9	28.6	—	127.0	8	5/8	19.1	63.5	2.9	3.6	3.6	2
12	7.9	31.8	—	149.2	8	3/4	22.2	76.2	4.2	5.3	5.4	2 1/2
12	9.5	34.9	—	168.3	8	3/4	22.2	92.2	5.9	7.2	7.3	3
12	9.5	39.7	—	184.2	8	7/8	25.4	104.9	7.4	9.2	10.0	3 1/2
14	11.1	36.5	—	200.0	8	7/8	25.4	117.6	9.7	11.9	12.3	4
16	11.1	42.9	—	235.0	8	7/8	25.4	144.5	13.2	16.4	16.8	5
18	12.7	46.0	—	269.9	12	7/8	25.4	171.5	15.9	20.8	22.7	6
20	12.7	50.8	—	330.2	12	1	28.6	222.3	24.7	32.2	36.7	8
20	12.7	55.6	—	387.4	16	1 1/8	31.8	276.4	35.7	46.6	56.7	10
25	12.7	60.3	—	450.9	16	1 1/4	34.9	328.7	51.6	69.0	83.9	12
25	12.7	63.5	—	514.4	20	1 1/4	34.9	360.4	69.8	93.4	113.4	14
25	12.7	68.3	—	571.5	20	1 3/8	38.1	411.2	87.6	119.6	133.8	16
30	12.7	69.9	—	628.7	24	1 3/8	38.1	462.0	108.7	150.5	179.2	18
30	12.7	73.0	—	685.8	24	1 1/2	41.3	512.8	134.5	184.4	229.1	20
30	12.7	82.6	—	812.8	24	1 3/4	47.6	614.4	203.0	274.7	358.3	24